



A NEW ERA OF SERENE LIVING



#### Address

Aasthaa Skyrise, Behind Solaris Business Hub  
Near Bhuyangdev Cross Roads, Sola Road, Ahmedabad-380063

#### Developer

Aasthaa Realty

#### Architect

Placekinesis Associates (PKA)

#### Structure

Bhoomi Consultant

#### MEP

Aashir Engineering

#### Contact

+91 9090105656

PR/GJ/AHMEDABAD/AHMEDABAD CITY/AUDA/MAA11886/010623  
([www.gujrera.gujarat.gov.in](http://www.gujrera.gujarat.gov.in))



Download Brochure



AASTHAA *skyrise*

## 3 & 4 BHK PEACEFUL LIVING

An Ideal Model of Luxury to Lead Your Way of Life.















Skyrise by Aasthaa is located in one of the prime locations of Ahmedabad. Experience the luxury catering to a lifestyle that encompasses serenity, nature and peace in the midst of alluring cityscape of Ahmedabad's Viewport.





# Lifestyle Amenities

Keeping in mind, every age group, Skyrise offers different leisure activities for each to develop and grow in the safety of the vicinity.

- |  |   |   |  |  |   |
|--|---|---|--|--|---|
| <br>Fitness Area      | <br>Indoor Games   | <br>Mini Theatre | <br>Toddler Room  | <br>Jogging Track | <br>Multipurpose Court |
| <br>Multipurpose Hall | <br>Kids Play Area | <br>Box Cricket  | <br>Swimming Pool | <br>Drop Off Zone | <br>Yoga Deck          |

## Experience Peace

Offering a galore of amenities and facilities that will allow the residents to experience life at its fullest. Skyrise is a premium residential project containing 3&4 BHK apartments that stand as the perfect example that proves an epitome of the luxury and lifestyle.











# Bhuyängdev

Bhuyangdev stands as one of the most quickly developing under-discovered areas in Ahmedabad, the first heritage city of India. With the connectivity of this area to Ahmedabad's premium culture of historical places, shopping avenues, food markets, restaurants, and religious heritage inclusive of temples and Derasars, this area is upcoming as a charm of Ahmedabad.

The purpose of our lives is to be happy.  
-Dalai Lama

## Home That Enlivens Opulence

Home is an abode for all your affections! While not everyone gets to decide on a destination that keeps them happy, you can be lucky to create your own life-style and revel in the familiar surrounding which you can call your own home.





---

## Kids Play Area

••

An in-house kids area assures safety of kids without missing out on their requirement to enjoy to the fullest. With fun and friendly play, a bubbly kids play area assures full entertainment for kids.

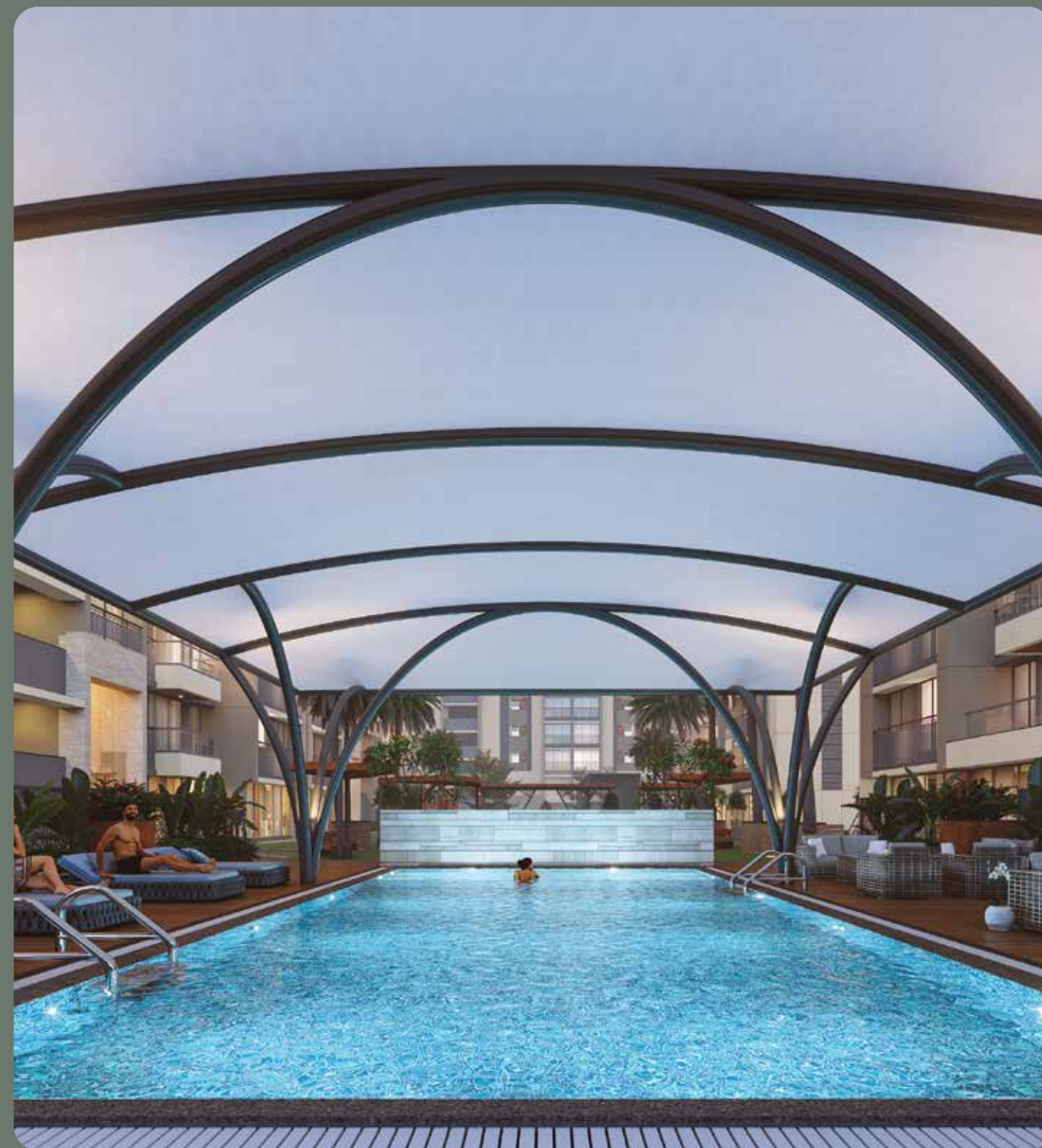

## Swimming Pool

••

---

With the aim of providing an improved lifestyle and standardized experience of luxury, we have installed a pool that actively helps in having a holistically healthy and fun life.



# Indoor Amenities

A living that inspires a quality lifestyle can be created only with the best amenities at hand. With an intensive outlook, we are here to create a strong connection between excellent infrastructure and a magnanimous lifestyle through an array of amenities that essentially cater to the needs of the residents.







Harmony • Tranquillity • Peace



18 MT Wide Road

12 MT Wide Road

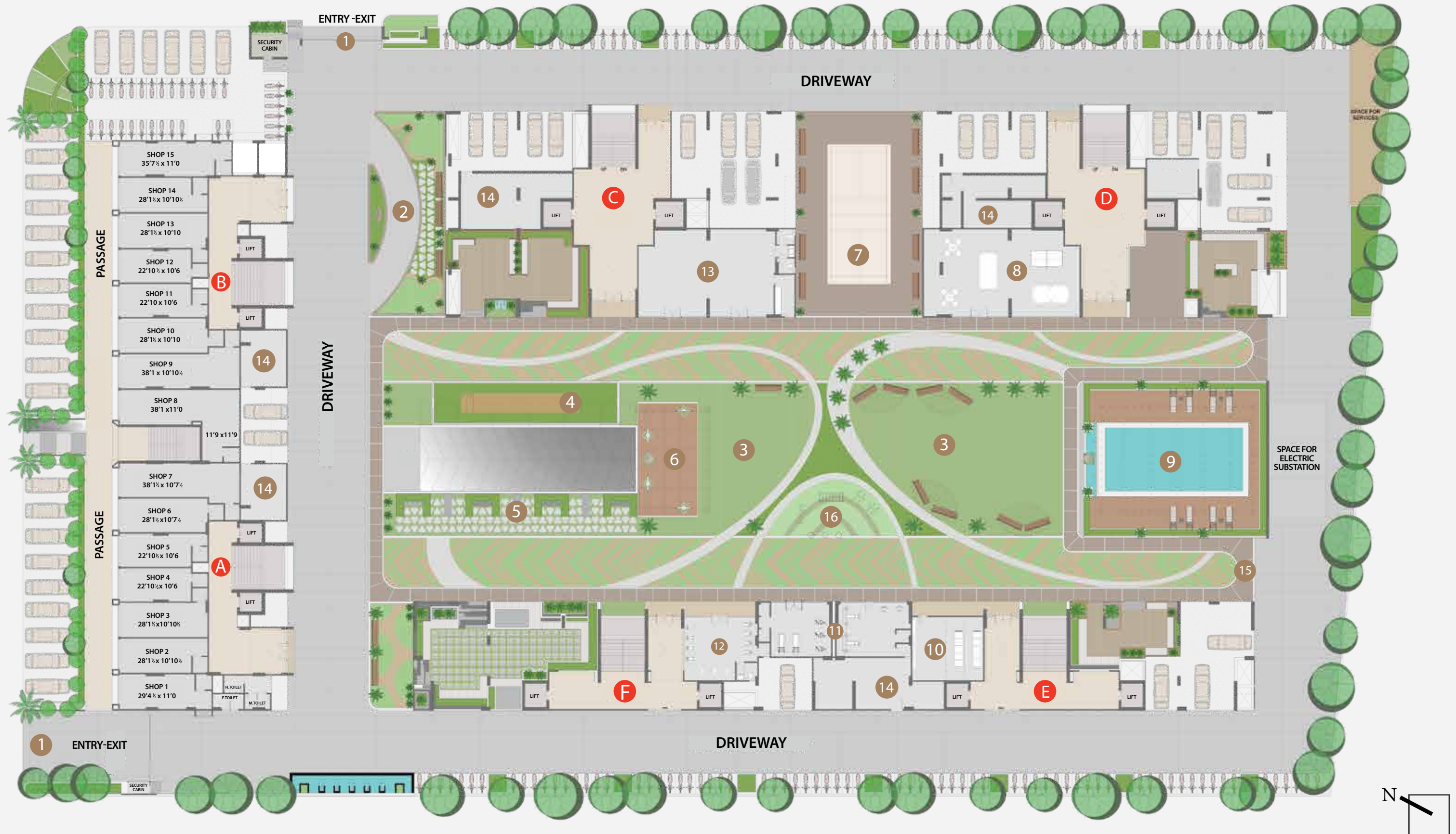

## Facilities at Ground Floor



18 MT Wide Road

12 MT Wide Road

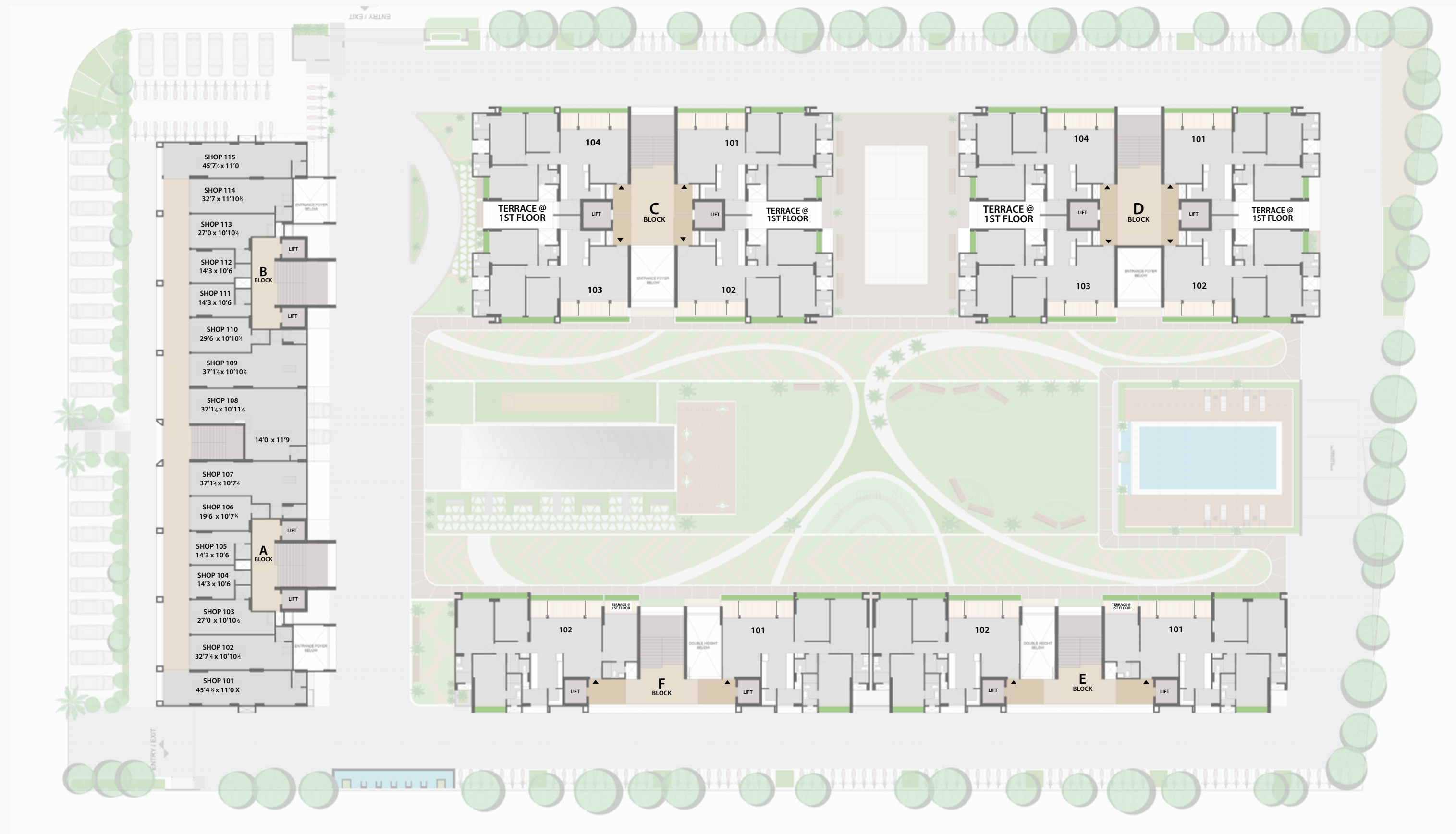

•• First Floor Plan





•• Typical Floor Plan



## • Infinite Views

With the aim of giving the benefit of privacy, we have curated apartments that offer stunning views all around bringing the breeze and the best views of the city in the bliss of your balcony.







Stunning and inviting from the inside out, Skyrise offers spacious and precisely proportioned living areas, airy fitted kitchens and opulent bathrooms.



Skyrise stands at one of the most breezy locations with 3 sides open apartments, allowing maximum ventilation.



•• 3BHK Unit Plan Type 1 ~ BLOCK A & B

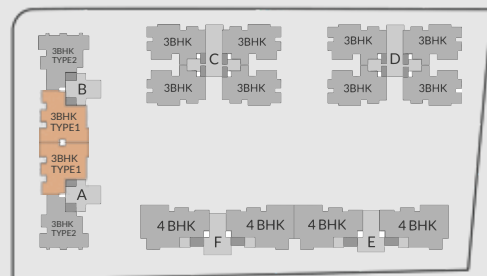

•• 3BHK Unit Plan Type 2 ~ Block A & B

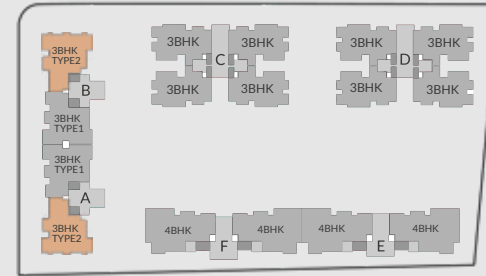



••3BHK Unit Plan ~ BLOCK C | D

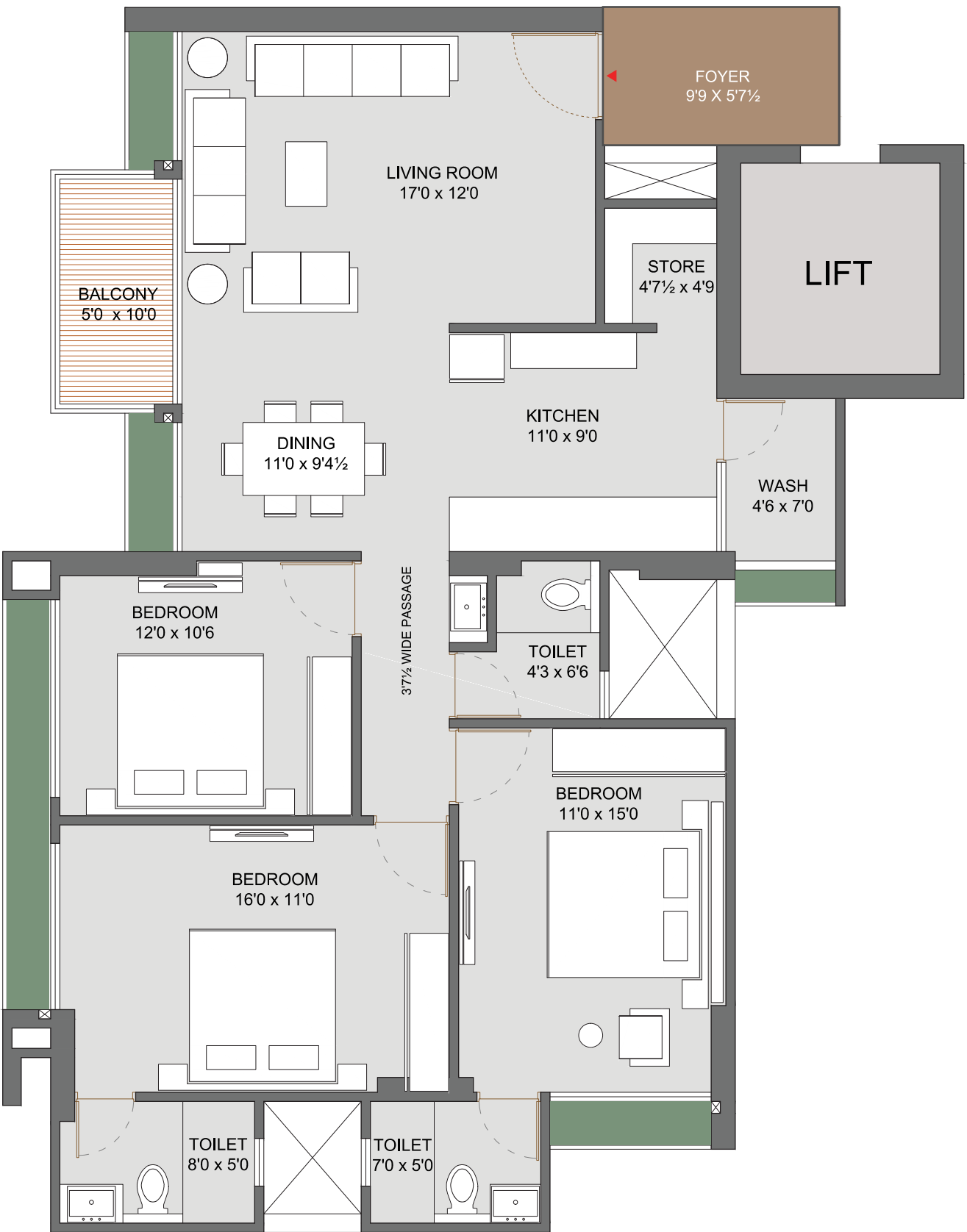
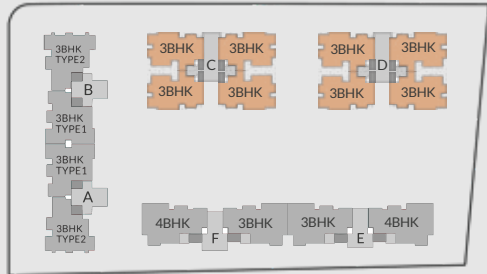

••3BHK Unit Plan ~ BLOCK E | F ~ 1st Floor

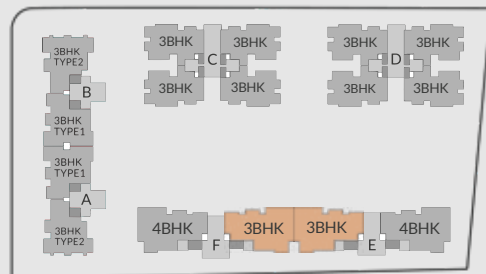



# ••4BHK Unit Plan ~ Block E & F

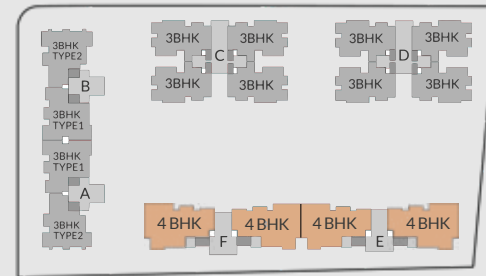



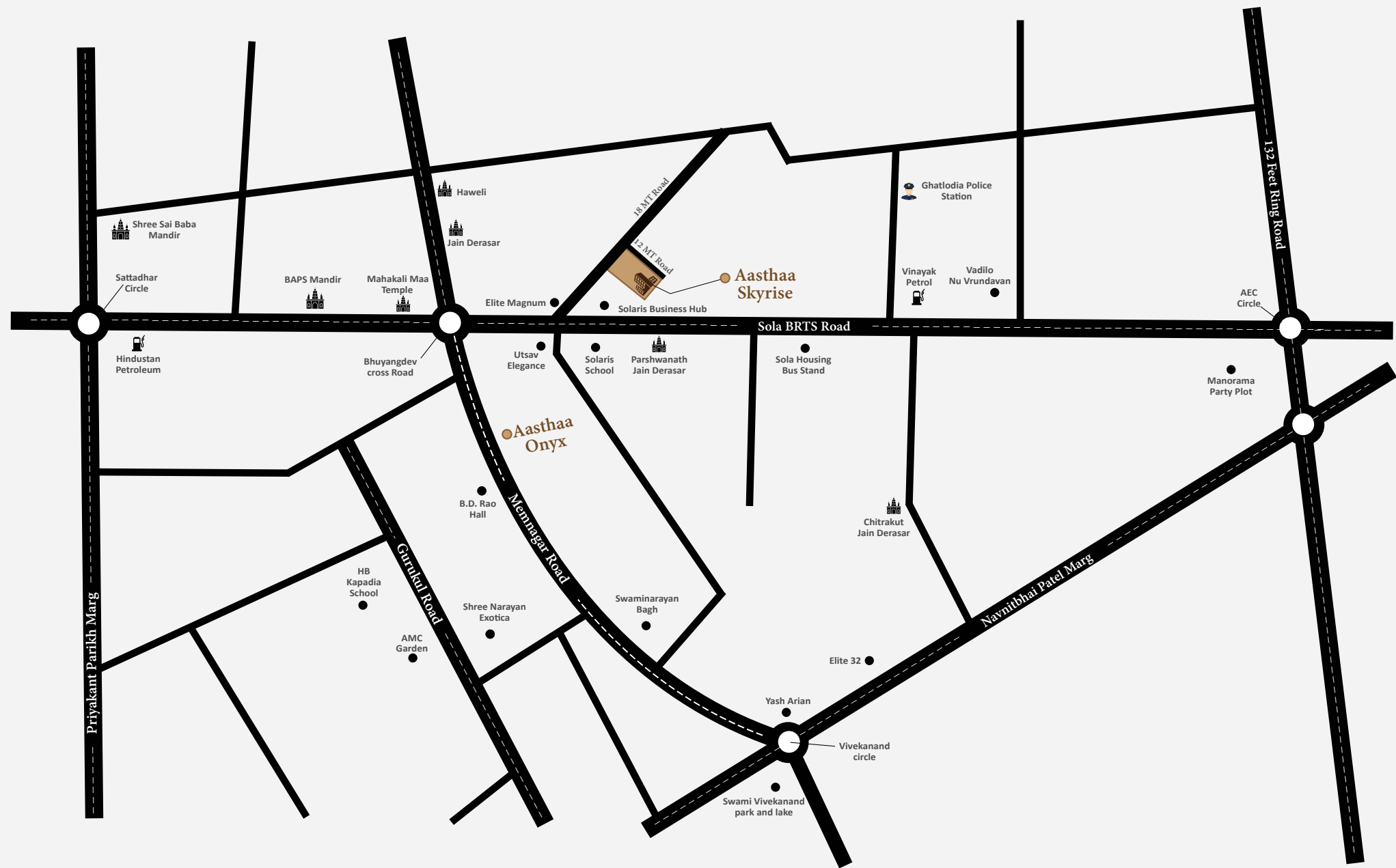

## Specifications

### STRUCTURE

Earthquake resistant RCC frame structure

### FLOORING

Vitrified tiles in all areas

### WATER SUPPLY

Hydro-pneumatic pressure system for water supply

### DOORS & WINDOWS

Decorative main door and other enamel painted/polished flush doors with wooden frame. Aluminium section sliding window with full glass and marble/granite sill.

### WALLS

All internal walls will be finished with white putty over mala plaster and external walls will be finished with plastic/texture finish with premium quality acrylic paints

### PLUMBING

Premium brand CPVC / UPVC pipes and fittings

### ELECTRIFICATION

3-phase concealed copper wiring with sufficient electrical points in drawing room & master bedroom, and AC point in all bedrooms. Centralized distribution board with MCBs and ELCBs for safety and protection.

### KITCHEN

Granite platform with S.S. sinks, designer glazed tiles dedo above platform up to lintel level

### PARKING

3 level Basement Parking



### Notes:

All the architectural interior images in the brochure are merely simulated interpretation using computer graphics to enhance the customer understanding and are not factual images.

The colour and general appearance of the flooring and wall tiles, sanitary ware & fittings, walls, ceiling, windows, doors, internal roads, trees, shrubbery etc. as shown in the simulated computer graphics are taken from libraries for the purpose of presentation and the prospective buyes of the concerned property are advised to refer to the construction specification

Additional amenities and or utilities not mentioned or shown in the brochure but may be required as per the law should be deemed to be forming part of the project by the purchaser.

All furniture including wardrobe, sofa & other electronic appliances like air conditioner, refrigerators, TVs, etc any equipment and household accessories inter-alia crockery, rugs, carpet, decorative pieces and wall hangings, wall paper and other consumable & movable items shown in stimulated image do not form part of any property by the developer.

All rights reserved with the developer to make any changes in the project as deemed necessary and all the members shall abide such changes.

GST, Stamp Duty, registration charges, and other charges and taxes as when levied by government or any of its body shall be borne by purchaser /buyer/possession holder.

Subject to Ahmedabad Jurisdiction Only